

NAIL DRILL M13 ALLELAC

Model: M13

Nr certyfikatu: UNIA22011511SC-02



TECHNICAL DATA:

Power: 68W

Rated input: 220V AC

Rated output: 12V 1.5A

Rotational speed: 35000 RPM

1. SAFETY INSTRUCTIONS:

1. Before first use, carefully read this instruction manual.
2. Make sure that the power supply voltage corresponds to the technical parameters of the nail drill.
3. Do not use the device in a humid or wet environment or in conditions of increased air humidity.
4. In case the nail drill is flooded or exposed to liquids, immediately disconnect it from the power supply. The device must not be used again and should be sent to an authorized service center for inspection and possible repair.
5. If the nail drill will not be used for a long period of time, disconnect it from the power supply.
6. If the housing becomes dirty, clean it with a soft, slightly damp cloth and a mild detergent. Cleaning must be performed only when the device is switched off and disconnected from the power supply.
7. Do not use cleaning agents with acidic properties or aggressive detergents.
8. Proper use and regular maintenance can significantly extend the service life of the nail drill.
9. In case of improper operation, contact a qualified service center. Do not attempt to repair the device yourself.
10. Keep the device out of reach of children.

2. SET CONTENTS:

- nail drill base unit
- handpiece
- drill bit set
- foot pedal
- user manual
- handpiece holder
- warranty card

3. DEVICE DESCRIPTION:

1. ON/OFF switch
2. Manual or foot operation selector (HAND/FOOT)
3. Rotation direction switch: forward/reverse (R/F)
4. Handpiece holder
5. Speed control knob
6. Handpiece input socket
7. Transformer (110 V or 220 V)
8. LCD display
9. Foot pedal input socket
10. Power cord
11. Drill bit holder
12. Handpiece (drill handle)

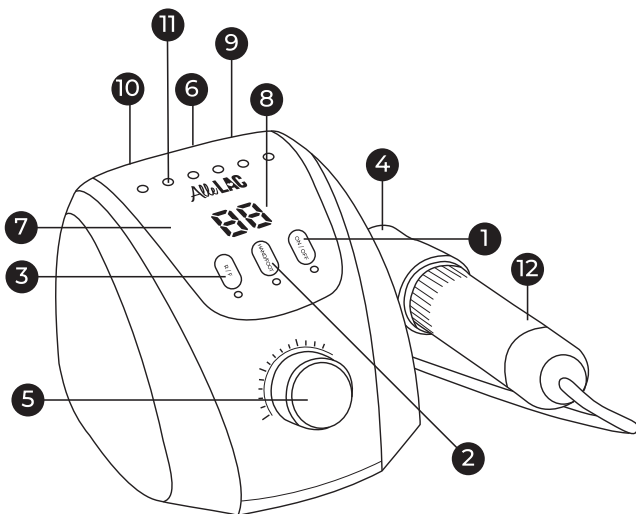

4. MAIN FEATURES:

The nail drill has been designed for professional manicure salons as well as for users performing nail styling at home. Its ergonomic design and comfortable handpiece ensure high working comfort, precision, and safe operation.

5. OPERATING INSTRUCTIONS:

1. Connect the power cord to the appropriate socket on the device.
2. Connect the handpiece to the appropriate input on the device.
3. Turn on the device using the ON/OFF switch.
4. Set the optimal rotational speed using the control knob. Turning the knob to the right increases the speed within the range of 0-35,000 RPM; turning it to the left decreases the speed.
5. Select the rotation direction (forward or reverse) according to your working needs.
6. Select the operating mode: manual or foot control (HAND/FOOT), depending on your preference.
7. After finishing work, switch off the device and disconnect the power cord from the mains socket.

6. USE AND MAINTENANCE GUIDELINES:

1. Always connect the device only to a power outlet with voltage compliant with the technical specifications.
2. Keep the device out of reach of children.
3. Clean the device using a dry or slightly damp cloth with a mild detergent.
4. Protect the device from moisture.
5. Avoid prolonged exposure to direct sunlight to prevent overheating.
6. Do not change drill bits while the device is operating, as this may cause permanent damage to the handpiece.
7. If the device will not be used for a long period, unplug it and store it in a dry, well-ventilated place.



In accordance with art. 13 sec. 1 of the Act of 11 September 2015 on used electrical and electronic equipment (Journal of Laws 2015 item 1688), we inform you about the correct handling of waste electrical and electronic equipment:

1. It is prohibited to place used electrical and electronic equipment together with other waste - this is confirmed by the marking in the form of a "crossed-out bin", which requires selective collection of this type of waste.
2. Electrical and electronic devices may contain hazardous substances, mixtures and components, which, after entering the environment, may pose a serious threat to the health and life of humans and living organisms.
3. Used electrical and electronic equipment should be transferred only to authorized collection points, the list of which should be included on the website of each Municipal Office.
4. Households play a key role in the waste management system for used electrical and electronic equipment due to the possibility of their direct transfer to authorized collection points and the elimination of undesirable social habits resulting in leaving waste equipment in places not intended for this purpose.

IMPORTER
GNBLAB sp. z o.o.
ul. Piotrkowska 270
90-361 Łódź, Polska
hurt.gnb-lab.com
uwagi@gnb-lab.com

Produced for:
Allepaznokcie Michał Szewczyk
ul. Piotrkowska 270, Łódź
allepaznokcie.pl

Made in PRC